

## Modello L02

- Motore a magneti permanenti
- Riduttore epicicloidale
- Stelo filettato trapezoidale o a ricircolo di sfere (VRS)
- Asta traslante in acciaio cromato
- Lubrificazione permanente a grasso
- IP 65, testato secondo norma CEI EN 60529
- Temperatura di funzionamento -10°C +60°C
- Impiego intermittente (vedi tabelle prestazionali) a 30°C\*
- Fine corsa a richiesta
- Encoder a richiesta

(\*) Per impieghi diversi contattare il Ns. Ufficio Tecnico

## Model L02

- Permanent magnet motor
- Planetary gearbox
- Acme lead screw or ballscrew (VRS)
- Chrome plated steel push rod
- Permanent grease lubrication
- IP 65, tested according to rule CEI EN 60529
- Working temperature range -10°C +60°C
- Intermittent duty (see performance charts) a 30°C\*
- Limit switches on request
- Encoder on request

(\*) For any special duty please contact our technical dept.

| L02 (Vdc) S3-30% 5 min |                             |                     |                             |                                     |                           |                        |                          |                                 |
|------------------------|-----------------------------|---------------------|-----------------------------|-------------------------------------|---------------------------|------------------------|--------------------------|---------------------------------|
| Fmax<br>Fmax<br>(N)    | Velocità<br>Speed<br>(mm/s) | Versione<br>Version | Taglia motore<br>Motor size | Giri motore<br>Motor speed<br>(rpm) | D vite<br>Screw D<br>(mm) | Passo<br>Pitch<br>(mm) | Rendimento<br>Efficiency | Corsa max<br>Max stroke<br>(mm) |
| 280                    | 100                         | M01                 | 36                          | 500                                 | 16                        | 12                     | 0.51                     | 795                             |
| 220                    | 60                          | M02                 | 36                          | 300                                 | 16                        | 12                     | 0.51                     | 800                             |
| 240                    | 40                          | M03                 | 36                          | 300                                 | 16                        | 8                      | 0.37                     | 800                             |
| 750                    | 30                          | M04                 | 36                          | 150                                 | 16                        | 12                     | 0.51                     | 795                             |
| 840                    | 20                          | M05                 | 36                          | 150                                 | 16                        | 8                      | 0.37                     | 800                             |
| 1600                   | 10                          | M06                 | 36                          | 150                                 | 16                        | 4                      | 0.32                     | 770                             |
| 2000                   | 5                           | M07                 | 36                          | 80                                  | 16                        | 4                      | 0.32                     | 690                             |

| L02 (Vdc) S3-10% 10 min |                             |                     |                             |                                     |                           |                        |                          |                                 |
|-------------------------|-----------------------------|---------------------|-----------------------------|-------------------------------------|---------------------------|------------------------|--------------------------|---------------------------------|
| Fmax<br>Fmax<br>(N)     | Velocità<br>Speed<br>(mm/s) | Versione<br>Version | Taglia motore<br>Motor size | Giri motore<br>Motor speed<br>(rpm) | D vite<br>Screw D<br>(mm) | Passo<br>Pitch<br>(mm) | Rendimento<br>Efficiency | Corsa max<br>Max stroke<br>(mm) |
| 800                     | 16                          | M08                 | 36                          | 80                                  | 16                        | 12                     | 0.51                     | 795                             |
| 900                     | 10                          | M09                 | 36                          | 80                                  | 16                        | 8                      | 0.37                     | 800                             |
| 1500                    | 5                           | M10                 | 36                          | 80                                  | 16                        | 4                      | 0.32                     | 795                             |

| L02 VRS (ballscrew) (Vdc) S3-30% 5 min |                             |                     |                             |                                     |                           |                        |                          |                                 |
|--|-----------------------------|---------------------|-----------------------------|-------------------------------------|---------------------------|------------------------|--------------------------|---------------------------------|
| Fmax<br>Fmax<br>(N)                    | Velocità<br>Speed<br>(mm/s) | Versione<br>Version | Taglia motore<br>Motor size | Giri motore<br>Motor speed<br>(rpm) | D vite<br>Screw D<br>(mm) | Passo<br>Pitch<br>(mm) | Rendimento<br>Efficiency | Corsa max<br>Max stroke<br>(mm) |
| 1000                                   | 42                          | M01                 | 36                          | 500                                 | 14                        | 5                      | 0.77                     | 765                             |
| 1000                                   | 25                          | M02                 | 36                          | 300                                 | 14                        | 5                      | 0.77                     | 790                             |
| 2000                                   | 12                          | M03                 | 36                          | 150                                 | 14                        | 5                      | 0.77                     | 560                             |
| 2000                                   | 6                           | M04                 | 36                          | 80                                  | 14                        | 5                      | 0.77                     | 560                             |

| L02 VRS (ballscrew) (Vdc) S3-10% 10 min |                             |                     |                             |                                     |                           |                        |                          |                                 |
|---|-----------------------------|---------------------|-----------------------------|-------------------------------------|---------------------------|------------------------|--------------------------|---------------------------------|
| Fmax<br>Fmax<br>(N)                     | Velocità<br>Speed<br>(mm/s) | Versione<br>Version | Taglia motore<br>Motor size | Giri motore<br>Motor speed<br>(rpm) | D vite<br>Screw D<br>(mm) | Passo<br>Pitch<br>(mm) | Rendimento<br>Efficiency | Corsa max<br>Max stroke<br>(mm) |
| 1500                                    | 6                           | M05                 | 36                          | 80                                  | 14                        | 5                      | 0.77                     | 645                             |

## DIAGRAMMI DI CORRENTE - CURRENT DIAGRAM

## DIAGRAMMI DI VELOCITÀ - SPEED DIAGRAM

### L02 (Vdc) s3-30% 5 min

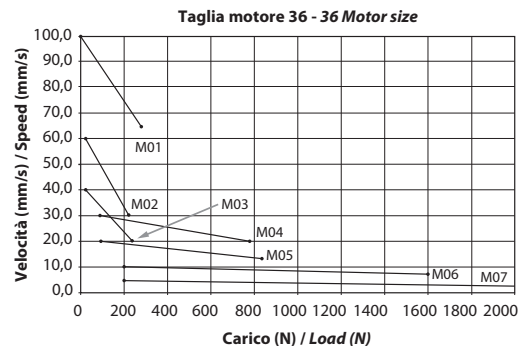
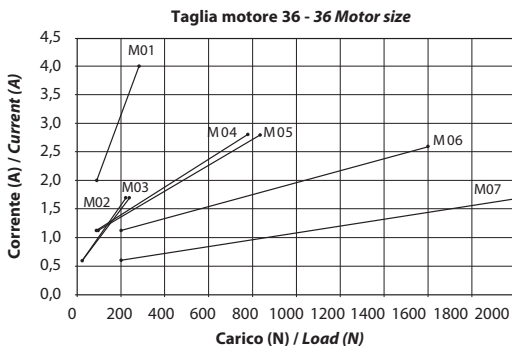

### L02 (Vdc) s3-10% 10 min

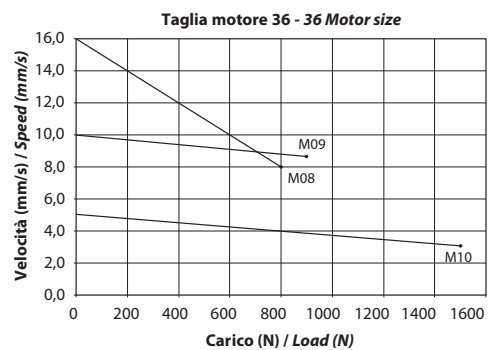
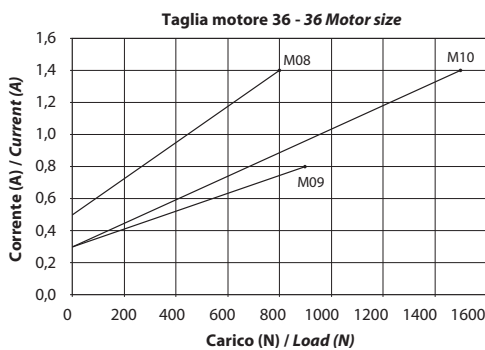

### L02 VRS (ballscrew) s3-30% 5 min

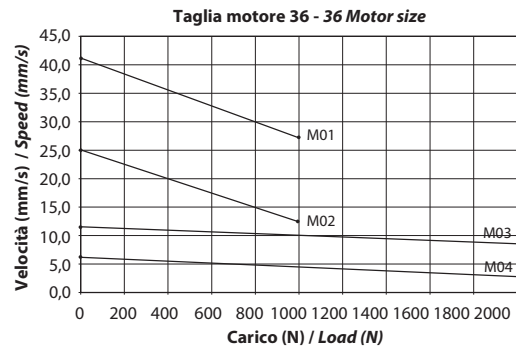
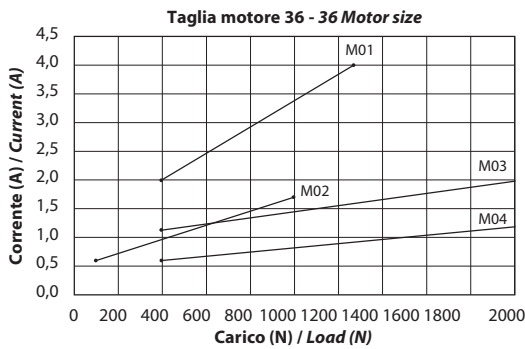

### L02 VRS (ballscrew) (Vdc) s3-10% 10 min

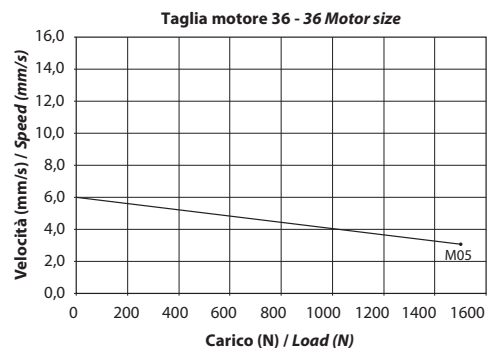
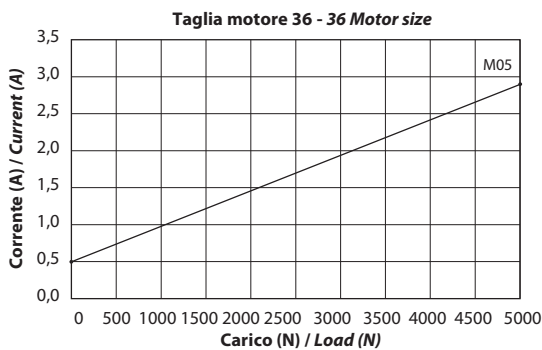

Diagrammi riferiti alla tensione di alimentazione 24Vdc.  
Per tensione 12Vdc raddoppiare il valore di corrente e ridurre il valore di carico del 20%.

Diagrams valid for 24Vdc power supply.  
For 12Vdc power supply currents are doubled and loads are 20% lower.

## ATTUATORE SENZA FINE CORSA / ACTUATOR WITHOUT LIMIT SWITCHES

### L02

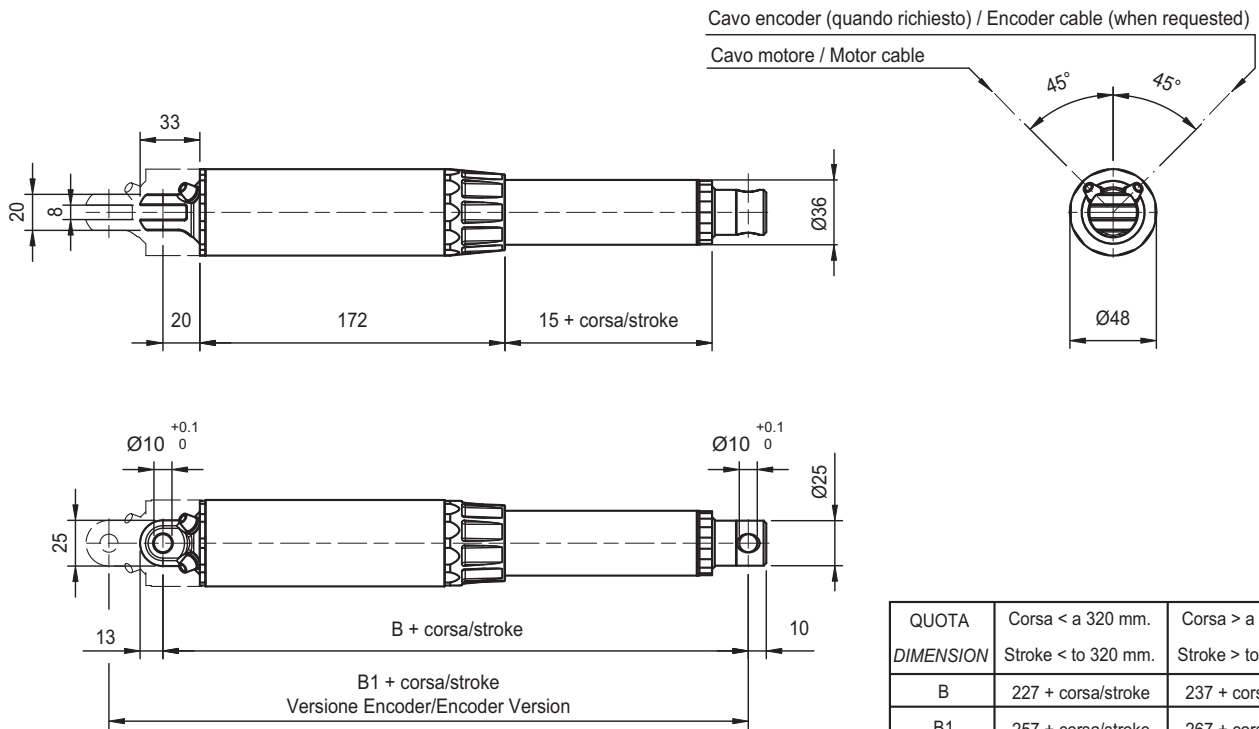

## ATTUATORE CON FINE CORSA ESTERNO / ACTUATOR WITH EXTERNAL LIMIT SWITCHES

### L02 - FCE

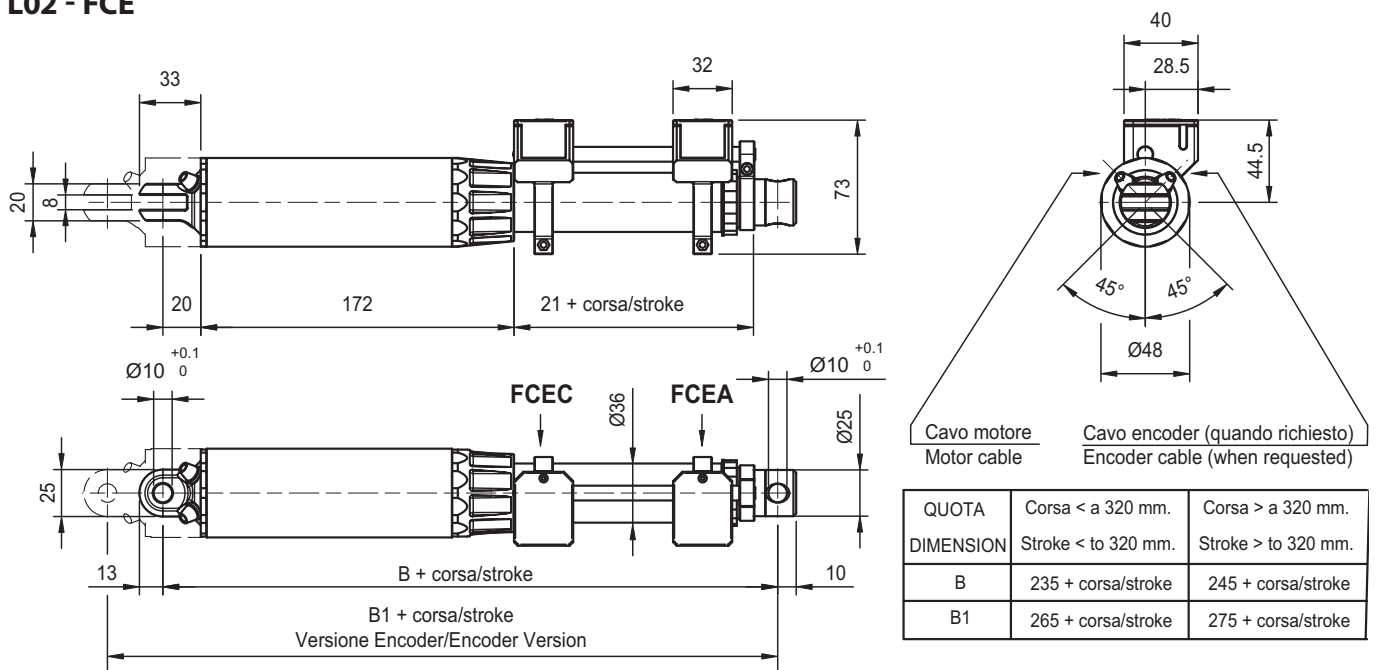

FCEC = Finecorsa meccanico chiusura  
FCEA = Finecorsa meccanico apertura

FCEC = Closing mechanical switch  
FCEA = Opening mechanical switch

## ATTUATORE CON FINE CORSA MAGNETICO / ACTUATOR WITH MAGNETIC LIMIT SWITCHES

### L02 - FCM

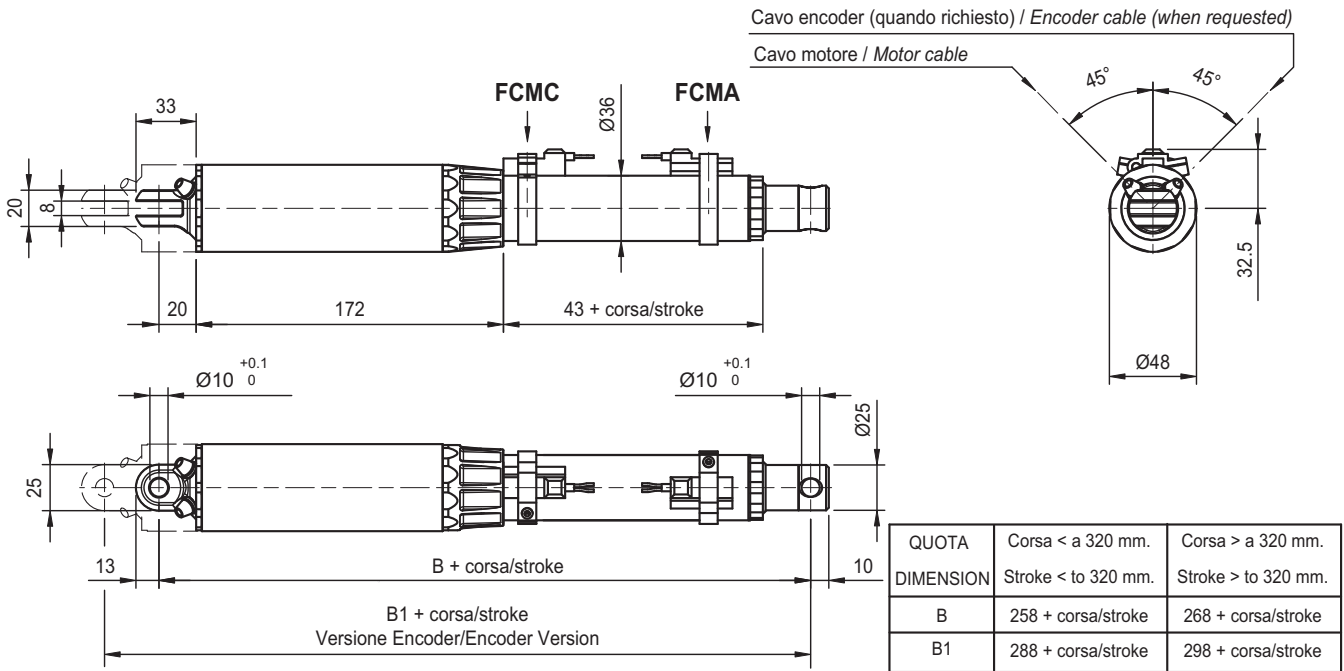

**FCMC** = Finecorsa magnetico chiusura  
**FCMA** = Finecorsa magnetico apertura

**FCMC** = Closing magnetic switch  
**FCMA** = Opening magnetic switch

## ATTUATORE CON STELO RICIRCOLO DI SFERE VRS SENZA FINE CORSA BALLSCREW ACTUATOR WITHOUT LIMIT SWITCHES

### L02 (ballscrew)

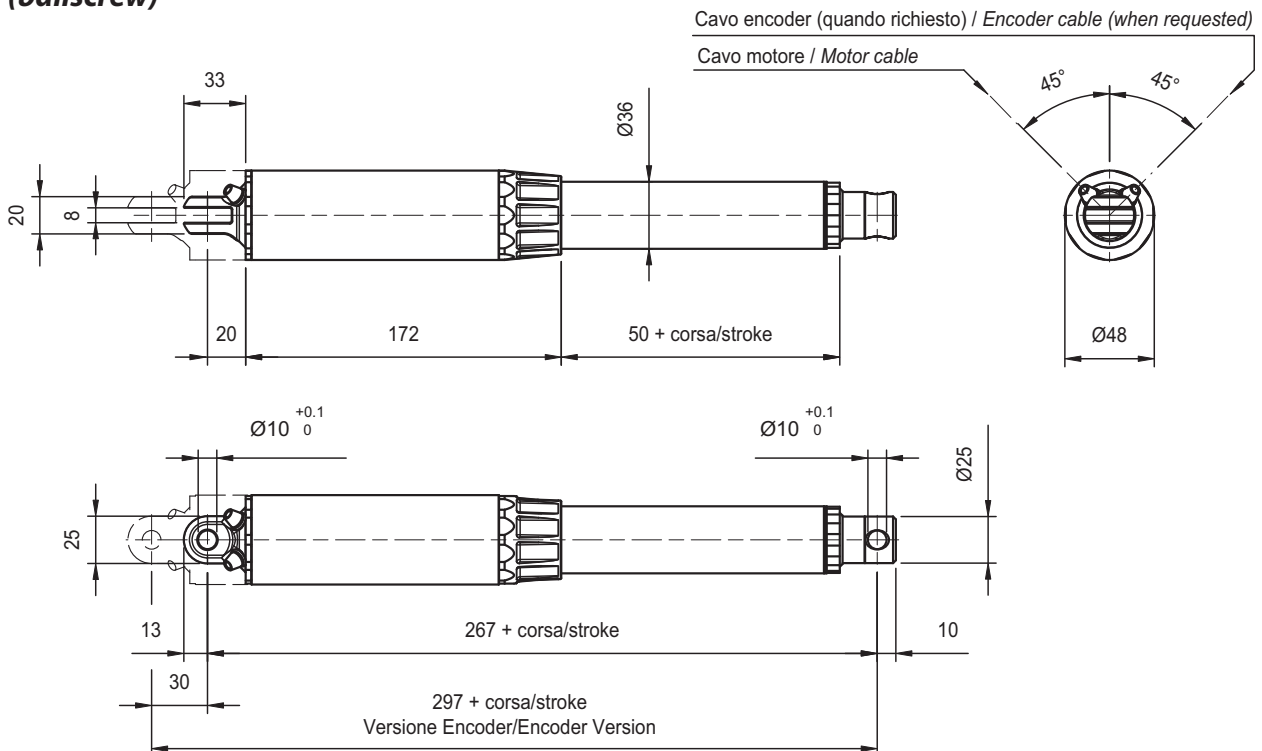

**ATTUATORE CON STELO VITE RICIRCOLO DI SFERE CON FINE CORSA ELETTRICO**

**BALLSCREW ACTUATOR WITH ELECTRICAL LIMIT SWITCHES**

**L02 - VRS - FCE**

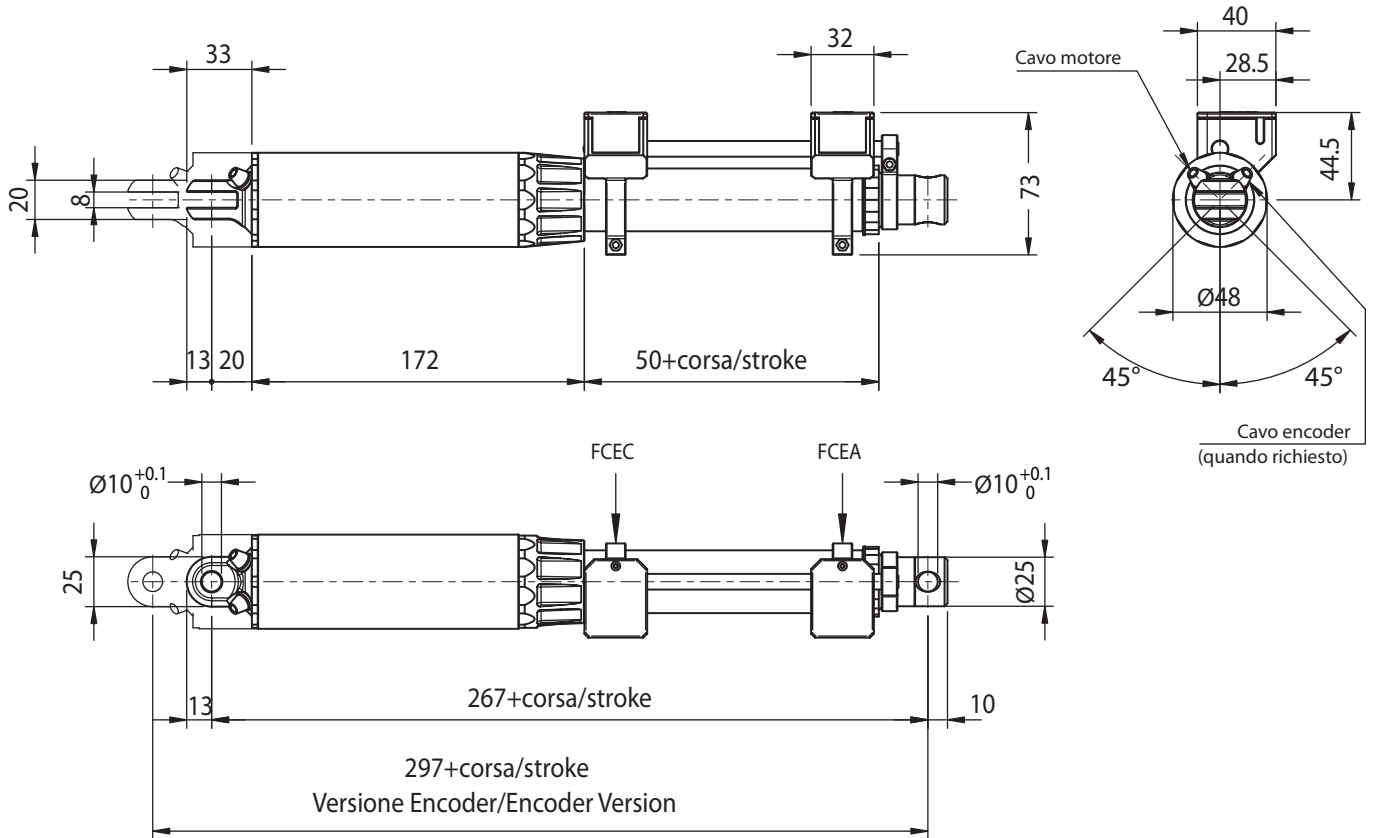

FCEC = Finecorsa meccanico chiusura / Closing mechanical switch  
 FCEA = Finecorsa meccanico apertura / Opening mechanical switch

## Attacchi anteriori

## Front ends

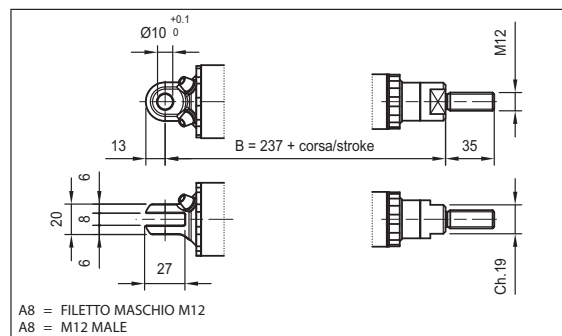
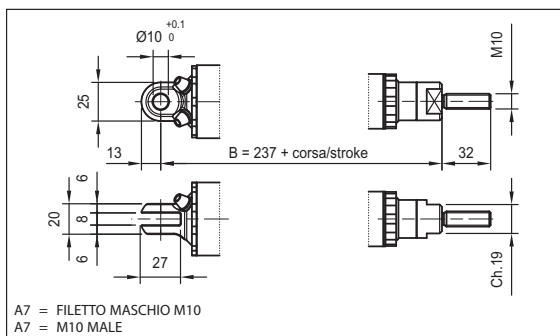
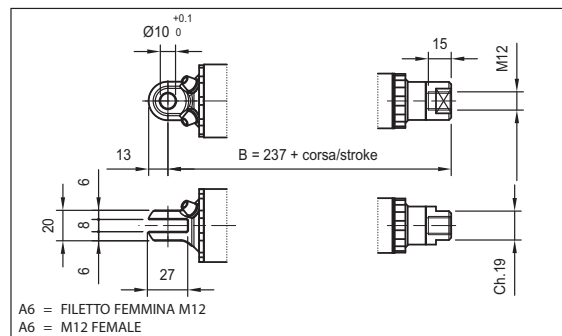
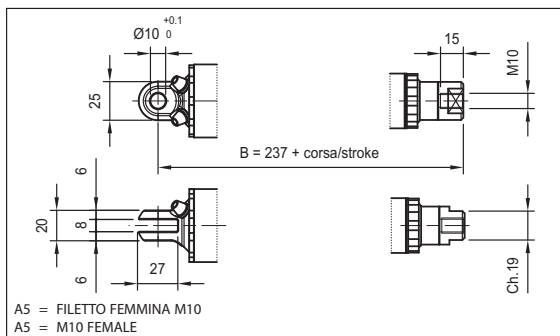
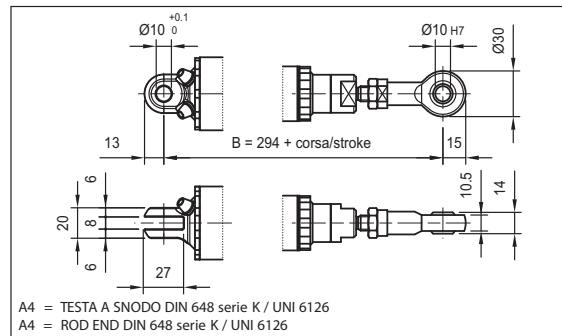
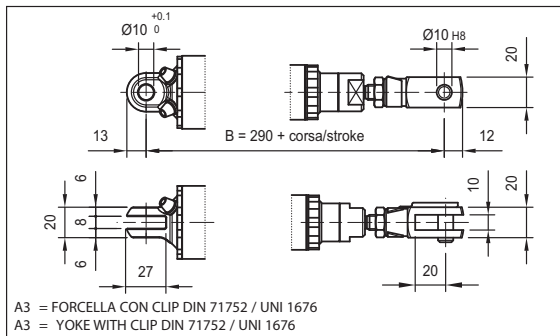
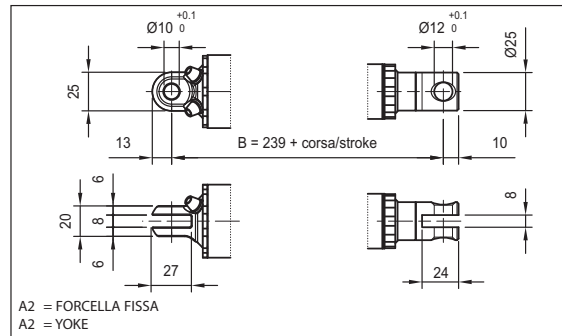
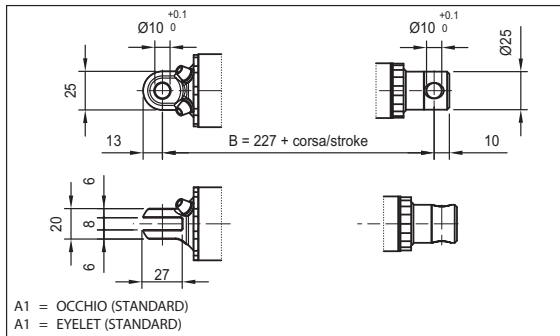

**Nota:** Variazioni quota "B" in base al modello

**Note:** "B" dimension changes according to model

**Nota:** In versione Encoder la quota "B" aumenta di 30 mm

**Note:** With encoder, dimension "B" is 30 mm longer

L02 = Vedi figure / See pictures

L02 corsa / stroke > 320 mm = + 10 mm

L02-FCE corsa / stroke < 320 mm = + 8 mm

L02-FCE corsa / stroke > 320 mm = + 18 mm

L02-FCM = + 34 mm

L02-FCM corsa / stroke > 320 mm = + 44 mm

con chiocciola di sicurezza "G" = + 30 mm / with safety nut "G" = + 30 mm

L02-VRS = + 40 mm

Protezione Soffietto/ Bellows + 20mm ( escluso versioni FCM e FCE/ no for versions FCM and FCE)